

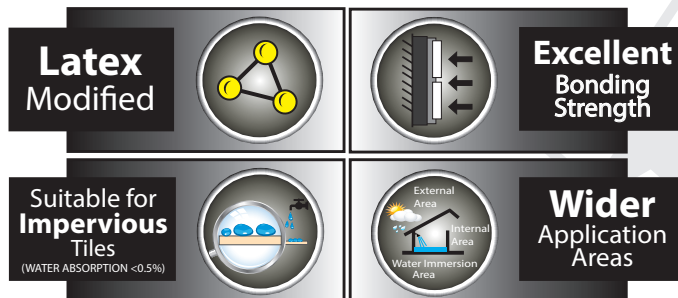

## DESCRIPTION

Ezi STAR FLEX 2in1 is a single part, latex modified, high performance, water resistant, semi-flexible cement-based adhesive. Conform to the requirement of : MS ISO 13007-1, classified as type C2.

## MAIN CHARACTERISTIC



## USAGE

### Suitable to use for :

- Wide range of impervious ceramic tiles (water absorption < 0.05%) and natural stones, e.g. porcelain tile, homogeneous tile, marble, granite etc.
- Thin-thick bed 3-6mm, and up to 12mm in small isolated area.
- Variety of substrates (refer to page 2).
- Wall/floor, internal/external, dry/wet areas, including water immersion area (e.g. swimming pool).

## PERFORMANCE & BENEFITS

- Latex Modified Single Part Adhesive**  
Special additives added provide greater characteristics.
- Excellent Bonding Strength**  
Able to fix various kind of tiles onto many substrates.
- High Adhesion & Cohesion Strength**  
Maximise cement hydration to attain optimum strength.
- User Friendly & Good Workability**  
Easy to use and provide excellent workability for greater productivity.
- Water Resistant Properties**  
Cured Tile adhesive bed will not be affected by water.
- Prevent Mixing Error**  
Avoid mixing error or abuse (only mix with clean water).
- Reduce Drying Shrinkage**  
Minimise shrinkage during drying period.
- Minimise Efflorescence**  
Provide adhesive bed with special additive which can minimise efflorescence & bleeding etc.

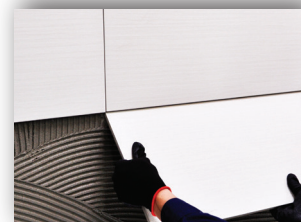

## PRODUCT INFORMATION

Name	: Ezi STAR FLEX 2in1
Packing	: 20 KG
Classification	: ISO 13007-1 Class C2
Shelf Life	: 12 Months in Cool & Dry Condition
Appearance	: Grey / White Fine Powder
Dry Solid Content	: 100%
pH Value	: Alkaline
Toxicity Hazard	: No
Inflammability	: No

## APPLICATION DATA (Tested at approx. 25 °C)

Mixing Ratio	: 3 pbw. Ezi STAR FLEX to 1 pbw. water (6-7L Water to 20Kg Ezi STAR FLEX 2in1)
Consistency of Mix	: Non-Slump Creamy Paste Form
Coverage	: Approx. 6-7 m <sup>2</sup> per bag (at 3 mm bed thickness)
Bed Thickness	: Recommended 3 - 6 mm
Slip Resistant	: Excellent
Workability	: Good (Smooth & Non-Slump)
Open Time	: Approx. 15 - 20 minutes
Adjustability Time	: Approx. 15 - 20 minutes
Pot Life	: Approx. 3 - 4 hours
Initial Set	: Approx. 8 - 10 hours
Light Foot Traffic	: Approx. 24 hours
Setting Time	: Approx. 24 - 48 hours
Application Temperature	: +5 °C and at Normal Ambient Temperature

## TECHNICAL DATA (Tested at approx. 25 °C)

Tensile Adhesion after 28 days air dry	: 2.5 ± 0.10 N/mm <sup>2</sup>
Tensile Adhesion after Water Immersion	: 2.3 ± 0.10 N/mm <sup>2</sup>
Tensile Adhesion after Heat Aging	: 2.0 ± 0.10 N/mm <sup>2</sup>
Resistance to Heat	: + 100 °C
Resistance to Frost	: - 5 °C
Resistance to Water	: Good
Resistance to Alkalies	: Good
Resistance to Acids	: Poor
Resistance to Oil & Solvent	: Fair
Flexibility	: Good

Tested in reference with the Requirement of:  
MS ISO 13007-1 Type C2